

CANADA'S DECORATING MAGAZINE

WIN! cookware cont

STYLE at HOME

organized for comfort

36 + pages
of kitchen inspiration

where
**DESIGN PROS
SHOP in
CANADA**

home office
**MAKEOVER
IDEAS to STEAL**

clutter-free living
family style

PM40064924 R08282

SEPTEMBER 2007

\$4.95



6 2343-971548 4

WWW.STYLEATHOME.COM



Most of the kitchen's core elements run up the centre of the room so as not to take away from the magnificent view of Vancouver. The refrigerator and full-length pullout pantry to the left of the seating area are part of the original kitchen. Made of solid granite, the backsplash is totally seamless – interior designer Patricia Gray had the electrical outlets relocated on the wall to the left of

the backsplash to avoid cutouts. **OPPOSITE, CLOCKWISE FROM LEFT** A built-in wine rack is inconspicuously stationed in what might have been wasted space within the gable end of the island. Throughout the space, the simplicity of the design allows for the dramatic contrast of stark white and warm teak elements, with silver-tone accents in the hood, tap and built-in soap dispenser.

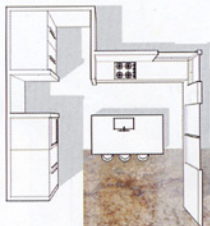

über view

When interior designer Patricia Gray first saw this penthouse kitchen, she says it was "dis-jointed and floating, with no focal point." Then again, with the jaw-dropping view of Vancouver, it's understandable why one might get distracted. Patricia took a minimalist approach and introduced a neutral palette, with teak cabinets that tie into the existing teak floor and a large, textural granite slab that's both backsplash and artwork. With the homeowners' two young kids in mind, she used practical materials, like leatherette for seating and quartz composite for a tabletop and counters. "The kids can drive their toy cars and colour on the table," Patricia says. "It's indestructible." ▸

we love this because...
A stunning teak-inlay ceiling that mimics the cabinetry and flooring grounds the space and breaks up the expansive white ceiling. The sculptural Moooi Dandelion chandelier adds a nice hit of white midair and reinforces circular shapes like the table and bar stools.



Teak ceiling panels, cabinetry and island, Rêdi Kitchen Studio. Paint, Stone (walls), Ultra White (trim, ceiling), Benjamin Moore. Desert Stone granite backsplash, Bordignon Marble & Granite. CaesarStone's Blizzard quartz composite counters and tabletop, White-Wood Distribution. Precision U Maxi sink, Blanco Canada. Dornbracht's Tara Classic faucet, soap dispenser and spray, Cantu. Moooi's Dandelion chandelier, LightForm.